

ǰǻ sic snpaǰnwix^wtn

Level 1 is primarily designated for learning and engagement spaces, including:

- A 200-seat active learning lecture hall
- Classrooms and teaching labs with 16-40 seats
- An inviting lounge space for building occupants and guests
- A new makerspace with adjacent design-think and finishing space

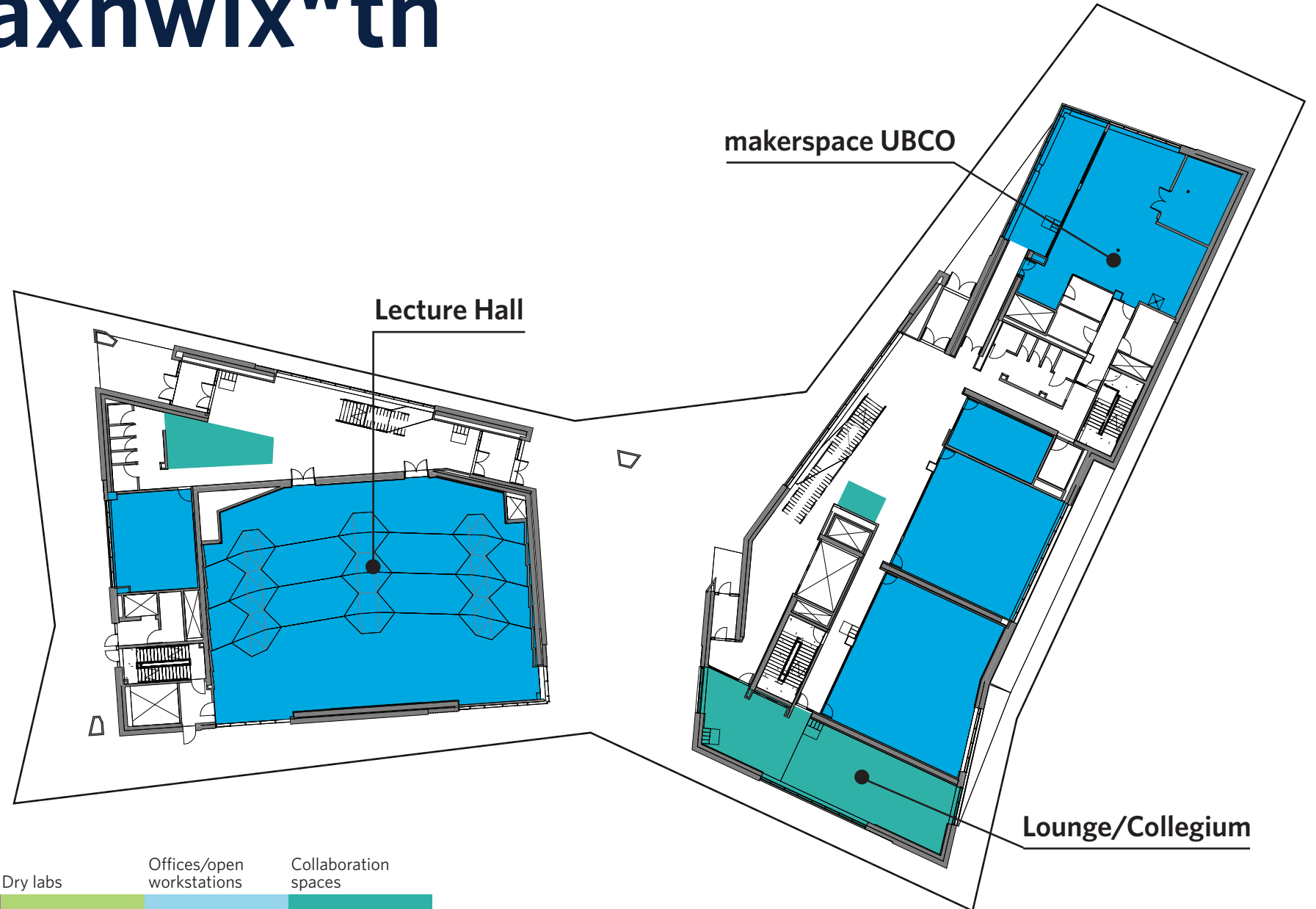

Classrooms/
teaching spaces

Wet labs

Dry labs

Offices/open
workstations

Collaboration
spaces

ǰəl sic snpaǰnwix^wtn

Level 2 is considered the social heart of the building. In addition to research and learning spaces, this level will house dedicated spaces for Indigenous programs and community engagement, including:

- A circular community gathering space (100 seats) designed in collaboration with the En'owkin Centre and the project's cultural working group
- An Indigenous student lounge and multipurpose community room
- Interior Salishan language labs, a Collections room, and offices for Elders
- Technology-enabled interview rooms and meeting rooms for community-engaged research
- Wet and dry research labs
- Offices and open workstations
- 3 kitchenettes

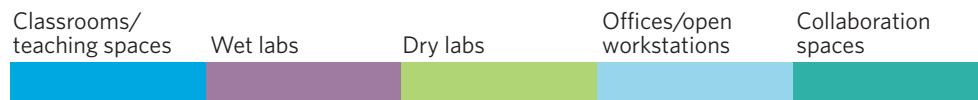
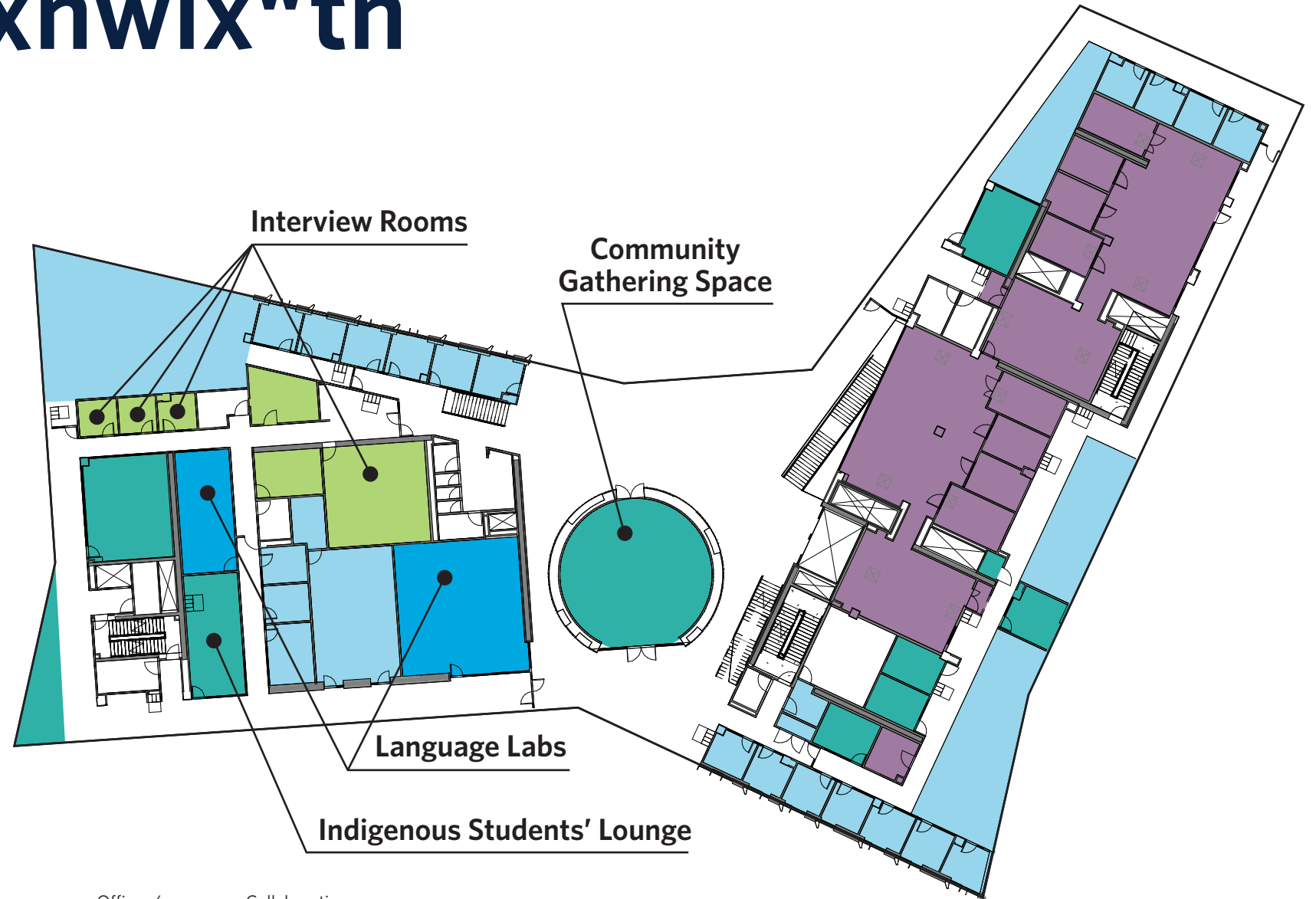

ǎəl sic snpaǎnwix^wtn

Level 3 brings interdisciplinary connections to life with a network of research and knowledge creation spaces nested among engagement spaces, including:

- Wet and dry research labs
- Technology-enabled conference and meeting rooms with 6-50 seats
- A thesis defence/seminar room
- A lounge for building occupants and guests
- Offices and open workstations
- Classrooms (16-40 seats)
- 3 kitchenettes

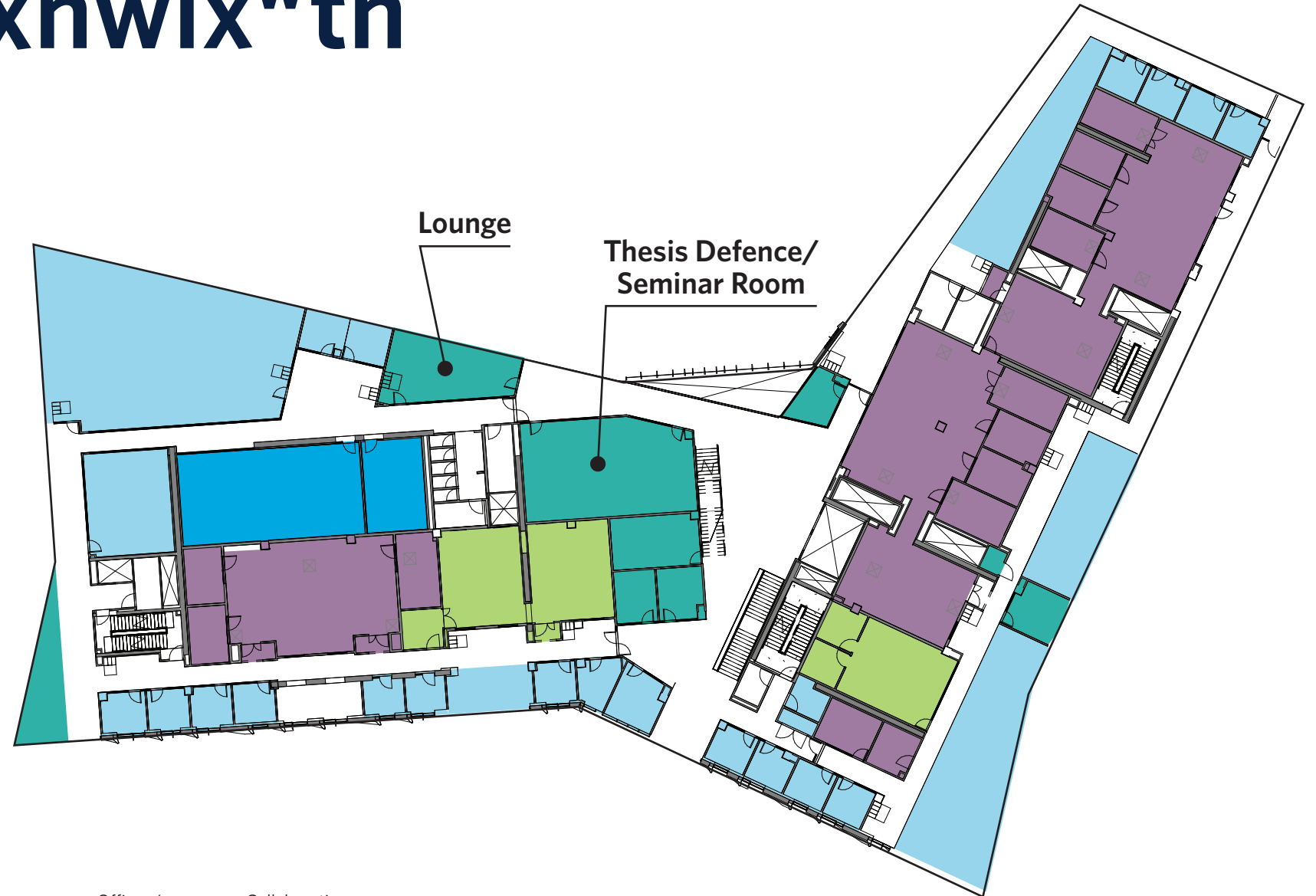

Classrooms/
teaching spaces

Wet labs

Dry labs

Offices/open
workstations

Collaboration
spaces

ǰəl sic snpaǰnwix^wtn

Level 4 marries interdisciplinary research and learning spaces, including:

- Wet and dry research labs
- Technology-enabled meeting and conference rooms ranging in size
- Classrooms (20-30 seats)
- Offices and open workstations
- 2 kitchenettes



Classrooms/
teaching spaces

Wet labs

Dry labs

Offices/open
workstations

Collaboration
spaces



ǰəl sic snpaǰnwix^wtn

The basement primarily houses building support functions (mechanical, electrical, etc.), along with two shared research facilities and end-of-trip facilities, including:

- Shared research facility: Imaging
- Shared research facility: Metabolomics
- Bike storage room
- Change rooms with showers and lockers

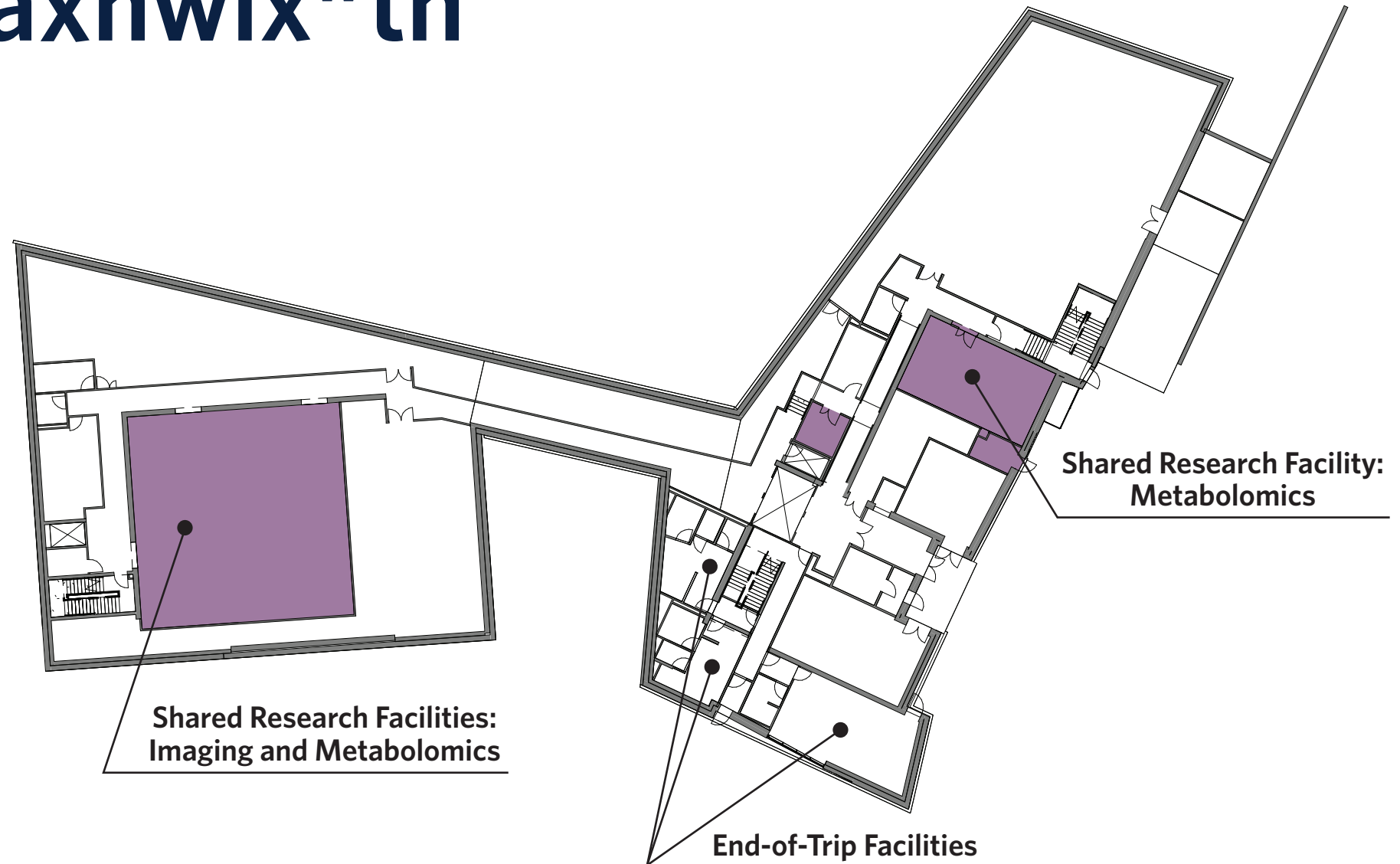

Classrooms/
teaching spaces

Wet labs

Dry labs

Offices/open
workstations

Collaboration
spaces

